



D-Sub Receptacle Right Angle Contact Solder Attachment For PE-SR402AL, PE-SR402FL, RG402

TECHNICAL DATA SHEET

PE4849

D-Sub Receptacle Right Angle Contact Solder Attachment For PE-SR402AL, PE-SR402FL, RG402

Configuration

| | |
|--|-----------------------------|
| Connector | D-Sub Receptacle |
| Connector Interface Type | PE-SR402AL,PE-SR402FL,RG402 |
| Cable Attachment Method (Shield/Contact) | Solder/Solder |
| Body Style | Right Angle |

Electrical Specifications

| | |
|-----------------|----|
| Impedance, Ohms | 50 |
|-----------------|----|

Mechanical Specifications

Size

| | |
|-----------------|---------------|
| Length, in [mm] | 0.765 [19.43] |
| Height, in [mm] | 0.458 [11.63] |
| Weight, lbs [g] | 0.006 [2.72] |

Connector

| | |
|------------------------------|------------------|
| Type | D-Sub Receptacle |
| Contact Material and Plating | Gold |
| Body Material and Plating | Brass, Gold |
| Dielectric Type | PTFE |

Compliance Certifications (visit www.Pasternack.com for current document)

| | |
|----------------|-----|
| RoHS Compliant | Yes |
|----------------|-----|

Plotted and Other Data

| | |
|--------|----------------------------|
| Notes: | Values at 25 °C, sea level |
|--------|----------------------------|

D-Sub Receptacle Right Angle Contact Solder Attachment For PE-SR402AL, PE-SR402FL, RG402 from Pasternack Enterprises has same day shipment for domestic and International orders. Our RF, microwave and fiber optic products maintain a 99% availability and are part of the broadest selection in the industry.

Click the following link (or enter part number in "SEARCH" on website) to obtain additional part information including price, inventory and certifications: [D-Sub Receptacle Right Angle Contact Solder Attachment For PE-SR402AL, PE-SR402FL, RG402 PE4849](http://www.pasternack.com/d-sub-receptacle-right-angle-contact-solder-attachment-for-pe-sr402al-pe-sr402fl-rg402-connector-pe4849)

URL: <http://www.pasternack.com/d-sub-receptacle-standard-pe-sr402al-pe-sr402fl-rg402-connector-pe4849-p.aspx>

The information contained in this document is accurate to the best of our knowledge and representative of the part described herein. It may be necessary to make modifications to the part and/or the documentation of the part, in order to implement improvements. Pasternack reserves the right to make such changes as required. Unless otherwise stated, all specifications are nominal.

PE4849 CAD Drawing

D-Sub Receptacle Right Angle Contact Solder Attachment
For PE-SR402AL, PE-SR402FL, RG402

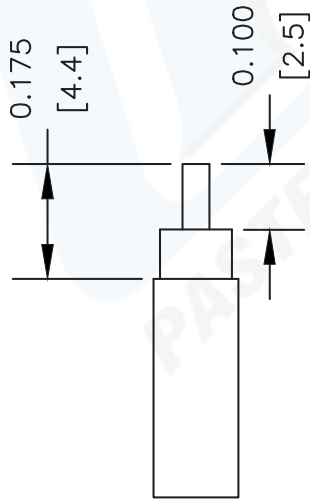
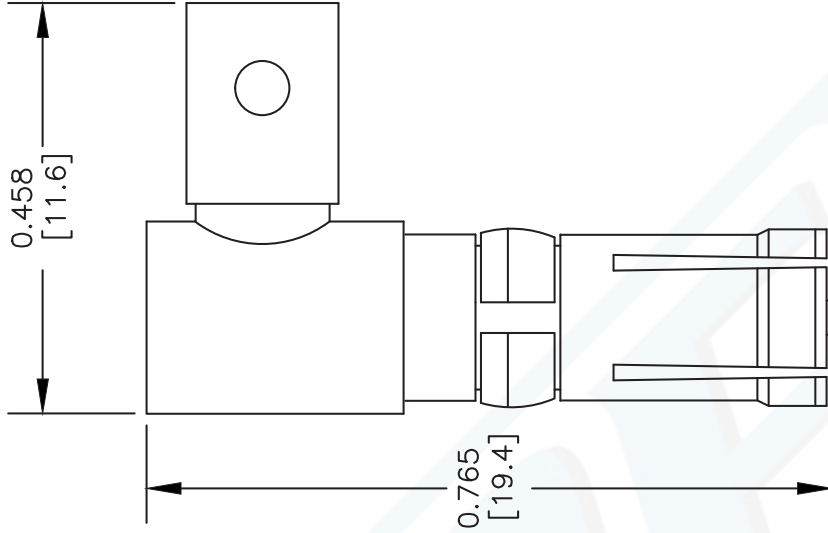

STRIPPING DIMENSIONS

ASSEMBLY PROCEDURES

1. STRIP CABLE AS SHOWN & TIN CENTER CONDUCTOR.
2. INSERT CABLE INTO BODY UNTIL IT BOTTOMS OUT.
3. SOLDER CENTER CONDUCTOR, OUTER CONDUCTOR & CAP IN

DWG TITLE

PE4849

FSCM NO. 53919

NOTES:
1. UNLESS OTHERWISE SPECIFIED ALL DIMENSIONS ARE NOMINAL.
2. ALL SPECIFICATIONS ARE SUBJECT TO CHANGE WITHOUT NOTICE AT ANY TIME.
3. DIMENSIONS ARE IN INCHES [mm].
4. FITS MIL-C-17 AND EQUIVALENT CABLES.

CAD FILE 061102

SCALE N/A

SIZE A

127



PASTERNAK[®]
Pasternack Enterprises, Inc.
P.O. Box 16759 | Irvine | CA | 92623
Phone: (949) 261-1920 | Fax: (949) 261-7451
Website: www.pasternack.com | E-Mail: sales@pasternack.com